



For lease

**208 Welsh Pool Road
Exton, PA**

Industrial Outdoor Storage

±41,000 SF warehouse

±4.25 Acres

Site Plan

Property Highlights

- Site Size: 4.25 acres
- Building Size: 41,000 SF
- Zoning: Planned Industrial (PI)
- Fully paved and lit with potential for site fencing
- Under new, professional ownership
- Multiple egress points with full circulation

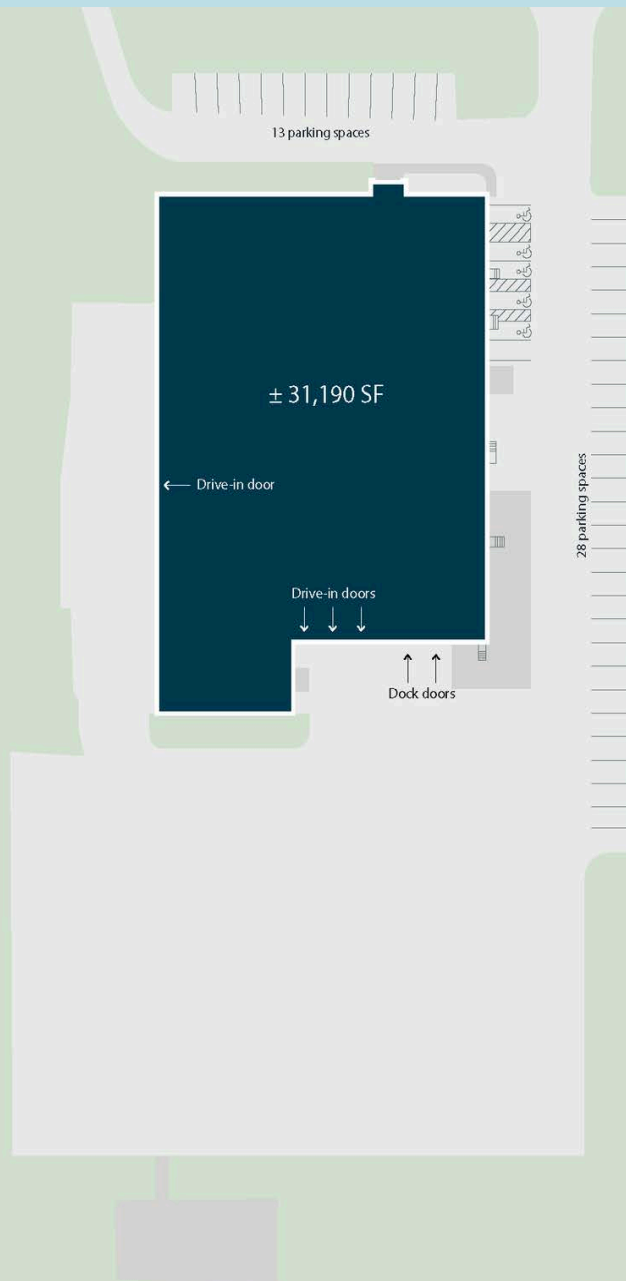

Building Plan

Building Highlights

- ±41,000 SF
- New roof
- Fully sprinklered
- 4 drive-in doors
- 2 dock doors
- 18' clear height
- Bi-level office space

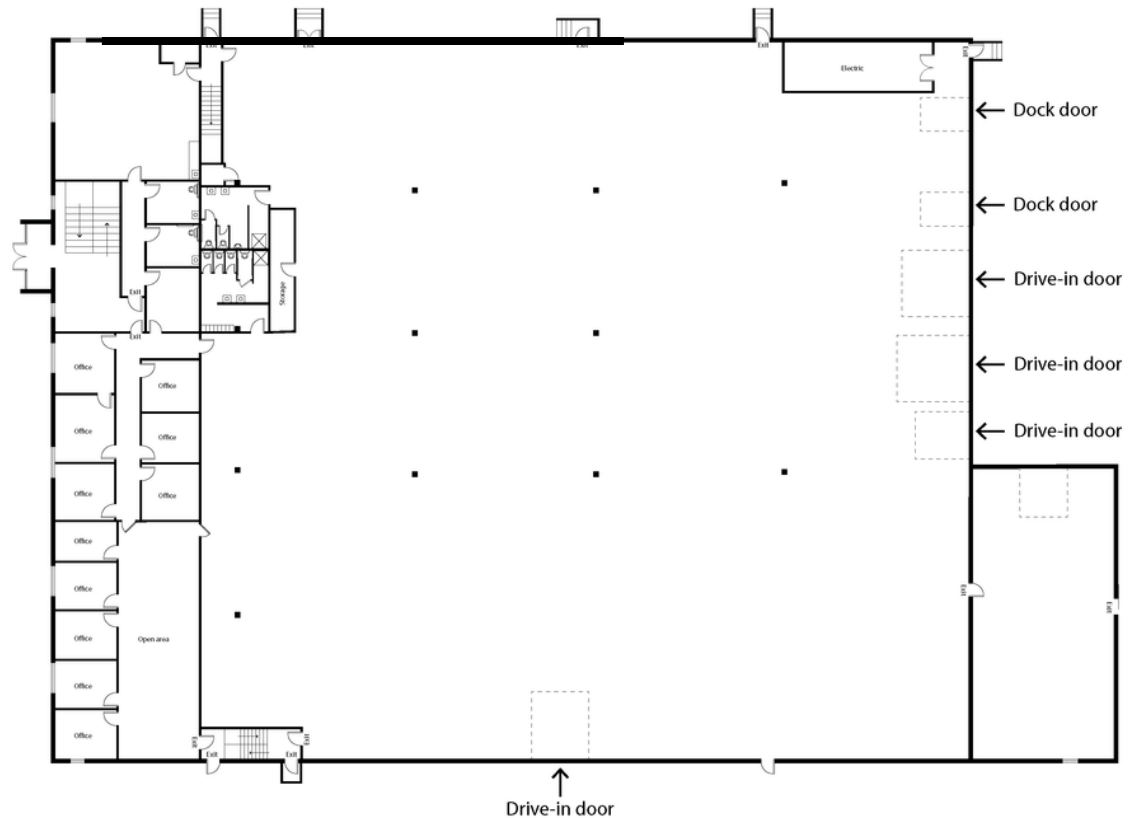

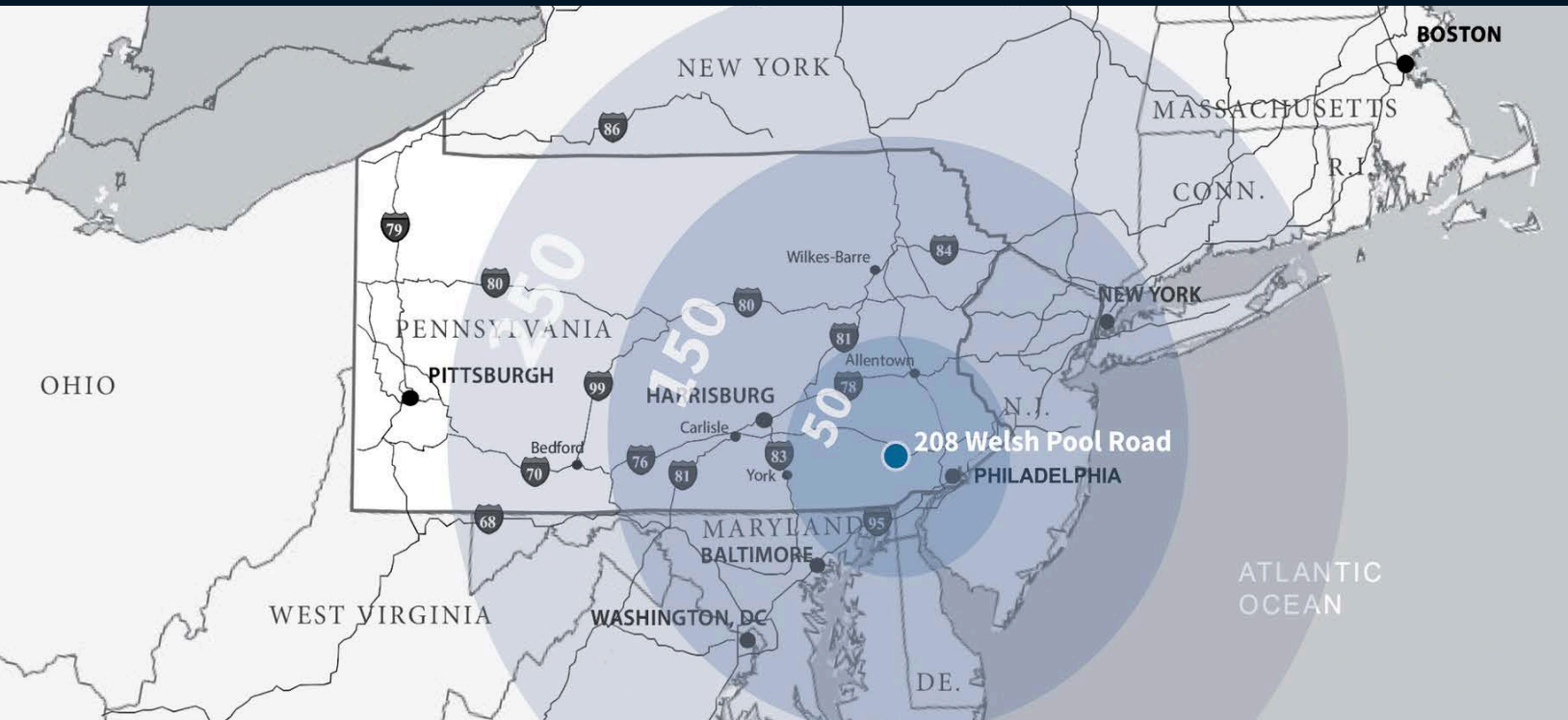

208 Welsh Pool Road

EXTON, PA

DISTANCES TO CITIES

	Distance (mi)	Drive Time (hrs)
Philadelphia, PA	35	40 min.
New York, NY	87	1 hr 40 min.
Baltimore, MD	119	1 hr. 50 min.
Washington, DC	126	2 hr. 30 min.
Boston, MA	331	5 hr. 30 min.

DISTANCES TO PORTS

Port of Philadelphia	27	45 min.
Port of Wilmington	40	50 min.
Port of Baltimore	91	1 hr 40 min.
Ports of NY/NJ	117	1 hr. 40 min.

- 8.2 million population within a 50-mile radius
- 395,295 labor force within a 30-minute drive time
- Efficient access to Route 202, Route 422, Pennsylvania Turnpike, & I-476
- Proximity to large industrial pockets in PA & NJ

DISTANCE TO AIRPORT

Philadelphia Airport	41	45 min.
JFK Airport	132	2 hr. 10 min.

DISTANCE TO INTERMODAL

CSX Philadelphia	41	50 min.
Norfolk Southern Morrisville	50	50 min.

Mitch Russell
mitch.russell@jll.com
+1 610 249 2274

Kyle Lockard
kyle.lockard@jll.com
+1 610 249 2299

Larry Maister
larry.maister@jll.com
+1 610 249 2297

jll.com

Although information has been obtained from sources deemed reliable, neither Owner nor JLL makes any guarantees, warranties or representations, express or implied, as to the completeness or accuracy as to the information contained herein. Any projections, opinions, assumptions or estimates used are for example only. There may be differences between projected and actual results, and those differences may be material. The Property may be withdrawn without notice. Neither Owner nor JLL accepts any liability for any loss or damage suffered by any party resulting from reliance on this information. If the recipient of this information has signed a confidentiality agreement regarding this matter, this information is subject to the terms of that agreement.
©2025. Jones Lang LaSalle IP, Inc. All rights reserved.